



# JUST LEASED

# ±6,882 Square Feet

13564 LARWIN CIRCLE | SANTA FE SPRINGS | CA



## PROPERTY FEATURES

- ± 6,882 SF Freestanding Industrial Building
- Approximately ± 1,000 SF Office Space
- 18' Minimum Warehouse Clearance Height
- 2 Ground Level Doors - 10'x10' and 12'x14'
- 600A, 277 / 480V 3 Phase Power
- Part of a Larger Master Planned Business Park
- Excellent Freeway Access   
- Interior Renovations to be Completed
- Available August 1, 2024

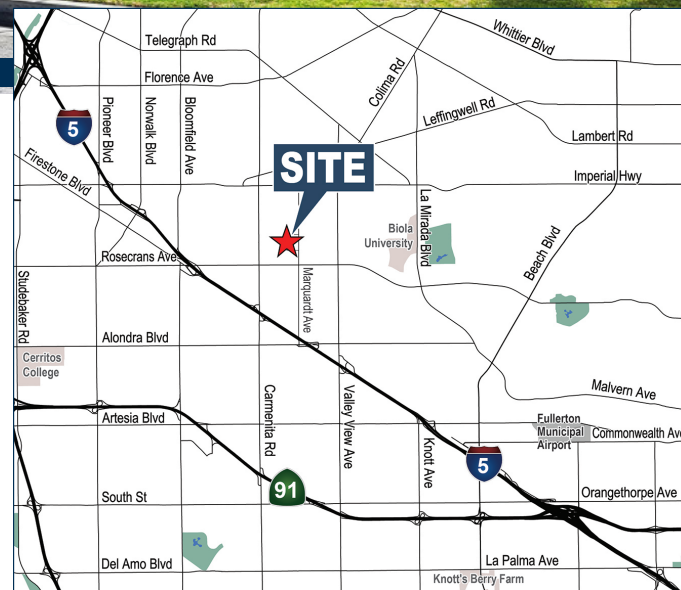

Exclusively Offered By:

**Voit**  
REAL ESTATE SERVICES

**CARGILE**  
COMMERCIAL GROUP

2020 Main Street, Suite 100 | Irvine, CA 92614  
License #01991785 www.voitco.com



**LOREN CARGILE**  
Vice President | Partner  
License #01431329

**(714) 935-2306**  
LCargile@voitco.com

13564 LARWIN CIRCLE | SANTA FE SPRINGS | CA

AERIAL



REAR OF BUILDING



Exclusively Offered By:

**Voit**  
REAL ESTATE SERVICES

**CARGILE**  
COMMERCIAL GROUP

2020 Main Street, Suite 100 | Irvine, CA 92614  
License #01991785 [www.voitco.com](http://www.voitco.com)



**LOREN CARGILE**  
Vice President | Partner  
License #01431329

**(714) 935-2306**  
[LCargile@voitco.com](mailto:LCargile@voitco.com)

SITE PLAN

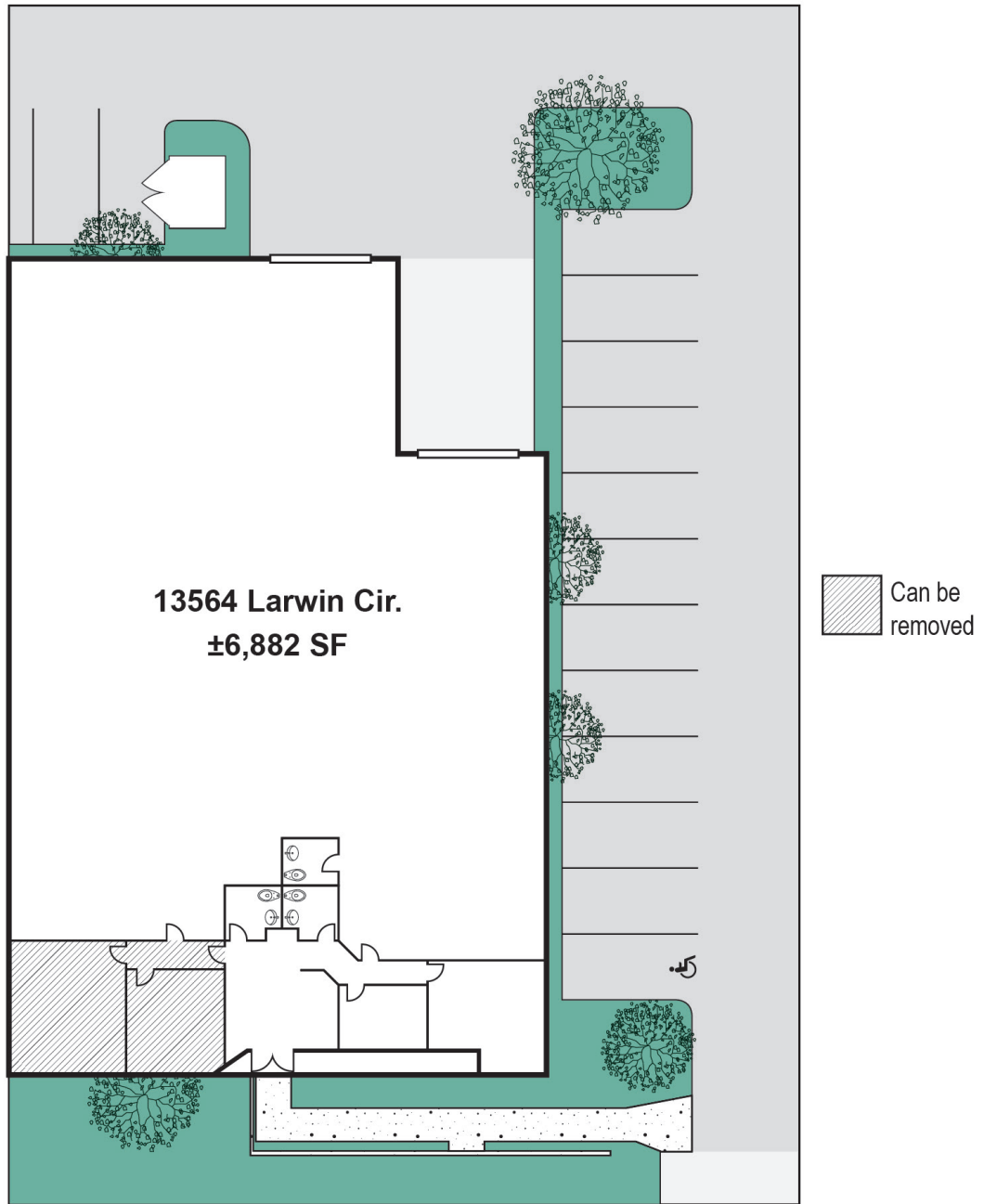

LARWIN CIR

Exclusively Offered By:

**Voit**  
REAL ESTATE SERVICES

**CARGILE**  
COMMERCIAL GROUP

2020 Main Street, Suite 100 | Irvine, CA 92614  
License #01991785 www.voitco.com



**LOREN CARGILE**  
Vice President | Partner  
License #01431329

**(714) 935-2306**  
LCargile@voitco.com