



# FOR LEASE

## ±13,814 SF INDUSTRIAL UNIT

1161 E. SANDHILL AVE | UNIT D | CARSON | CA



### PROPERTY FEATURES

- ±13,814 SF Corner Unit
- ±2,225 SF Office (Two Story)
- 22-24' Warehouse Clearance
- 600A, 277/480V 3 Phase Power (Verify)
- Fire Sprinklers
- 2 DH Positions (Partial Interior)
- 1 Oversized GL Door (12' x 14')
- Large Fenced Yard
- Excellent Access to the , , and  Freeways

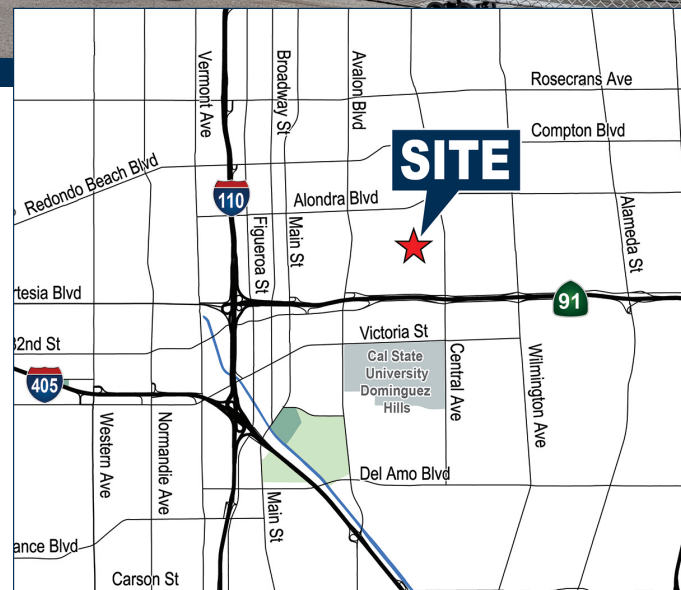

Exclusively Offered By:

## Voit

REAL ESTATE SERVICES

2020 Main Street, Suite 100 | Irvine, CA 92614  
License #01991785 www.voitco.com



**LOREN CARGILE**  
Vice President | Partner  
License #01431329

**(424) 329-7515**  
LCargile@voitco.com



**MIKE CARGILE**  
Senior VP | Partner  
License #00491668

**(949) 263-5338**  
MCargile@voitco.com

FLOOR PLAN

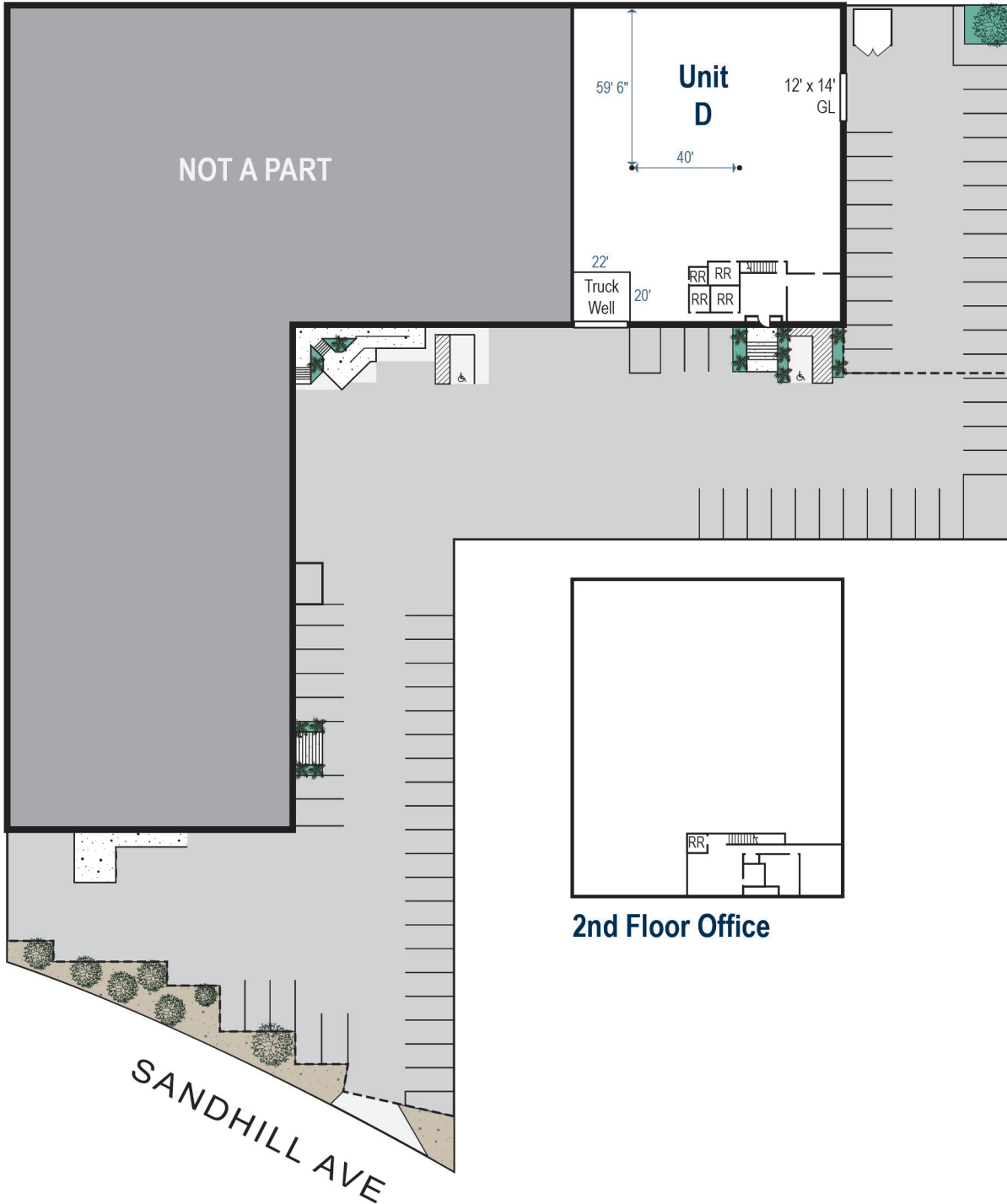

Exclusively Offered By:

**Voit**

REAL ESTATE SERVICES

2020 Main Street, Suite 100 | Irvine, CA 92614  
License #01991785 www.voitco.com



**LOREN CARGILE**  
Vice President | Partner  
License #01431329

**(424) 329-7515**  
LCargile@voitco.com



**MIKE CARGILE**  
Senior VP | Partner  
License #00491668

**(949) 263-5338**  
MCargile@voitco.com

1161 E. SANDHILL AVE | UNIT D | CARSON | CA

EXTERIOR PHOTOS



Exclusively Offered By:

**Voit**

REAL ESTATE SERVICES

2020 Main Street, Suite 100 | Irvine, CA 92614  
License #01991785 [www.voitco.com](http://www.voitco.com)



**LOREN CARGILE**  
Vice President | Partner  
License #01431329

**(424) 329-7515**  
[LCargile@voitco.com](mailto:LCargile@voitco.com)



**MIKE CARGILE**  
Senior VP | Partner  
License #00491668

**(949) 263-5338**  
[MCargile@voitco.com](mailto:MCargile@voitco.com)