





# FOR LEASE

**±60,150 SF**  
**FREESTANDING INDUSTRIAL PROPERTY**

**1547 S STATE COLLEGE BLVD | ANAHEIM, CA**



## PROPERTY FEATURES

- Highly Desirable “Tile Mile” Location
- ± 60,150 SF Freestanding Building
- ± 3,544 SF of Office
- 4 Dock High Doors (1 Via Shared Platform)
- 2 Ground Level Doors (One Oversized Door)
- ± 18'-24' Warehouse Clearance
- Large Fenced Yard
- Shop Restrooms
- 1200 Amps, 277/480V 3 Phase Power (Verify)
- Fully Fire Sprinklered
- Excellent Access to the  ,  ,  and  Freeways

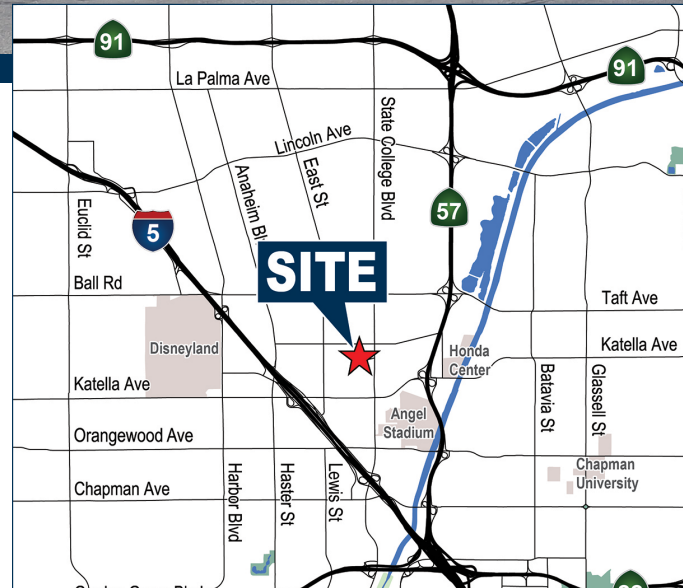

Exclusively Offered By:

## Voit

REAL ESTATE SERVICES

2020 Main Street, Suite 100 | Irvine, CA 92614  
License #01991785 [www.voitco.com](http://www.voitco.com)



**LOREN CARGILE**  
Vice President | Partner  
License #01431329

**(714) 935-2306**  
[LCargile@voitco.com](mailto:LCargile@voitco.com)



**MIKE CARGILE**  
Senior VP | Partner  
License #00491668

**(949) 263-5338**  
[MCargile@voitco.com](mailto:MCargile@voitco.com)



# 1547 S STATE COLLEGE BLVD | ANAHEIM, CA - ±60,150 SF

## AERIAL



## SITE PLAN

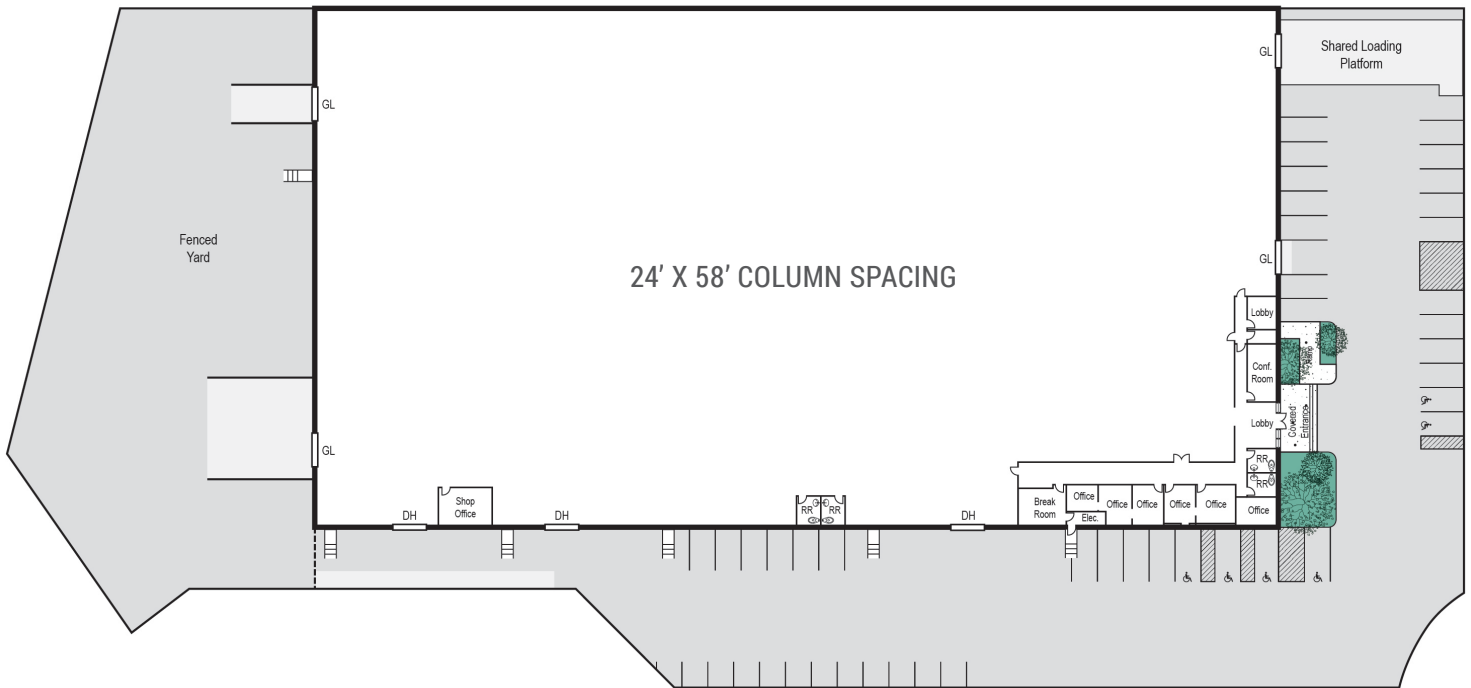

Exclusively Offered By:

# Voit

REAL ESTATE SERVICES

2020 Main Street, Suite 100 | Irvine, CA 92614  
License #01991785 [www.voitco.com](http://www.voitco.com)



**LOREN CARGILE**  
Vice President | Partner  
License #01431329

**(714) 935-2306**  
[LCargile@voitco.com](mailto:LCargile@voitco.com)



**MIKE CARGILE**  
Senior VP | Partner  
License #00491668

**(949) 263-5338**  
[MCargile@voitco.com](mailto:MCargile@voitco.com)