

JUST LEASED!

± 13,330 SF INDUSTRIAL BUILDING

12200 LOS NIETOS ROAD, SANTA FE SPRINGS, CA



PROPERTY FEATURES

- ± 13,330 SF Industrial Building
- ± 2,000 SF Office
- Bonus Mezzanine
- Two Fenced Yards
- 4 Ground Level Doors
- 1 Truckwell Door
- 12' Minimum Warehouse Clearance
- Fire Sprinklers
- 1,000 Amps, 277/480 V 3 Phase Power (Verify)
- Access to Multiple Nearby Freeways, Including



- Available Now

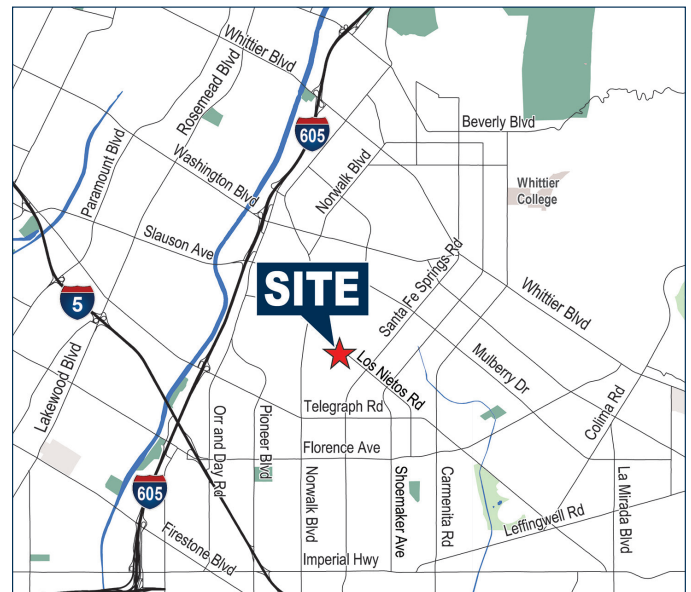

Exclusively Offered By:

Voit

REAL ESTATE SERVICES

2020 Main Street, Suite 100 | Irvine, CA 92614
License #01991785 www.voitco.com



LOREN CARGILE
Vice President | Partner
License #01431329

(714) 935-2306
LCargile@voitco.com



MIKE CARGILE
Senior VP | Partner
License #00491668

(949) 263-5338
MCargile@voitco.com

12200 LOS NIETOS ROAD, SANTA FE SPRINGS, CA

AERIAL



SITE PLAN

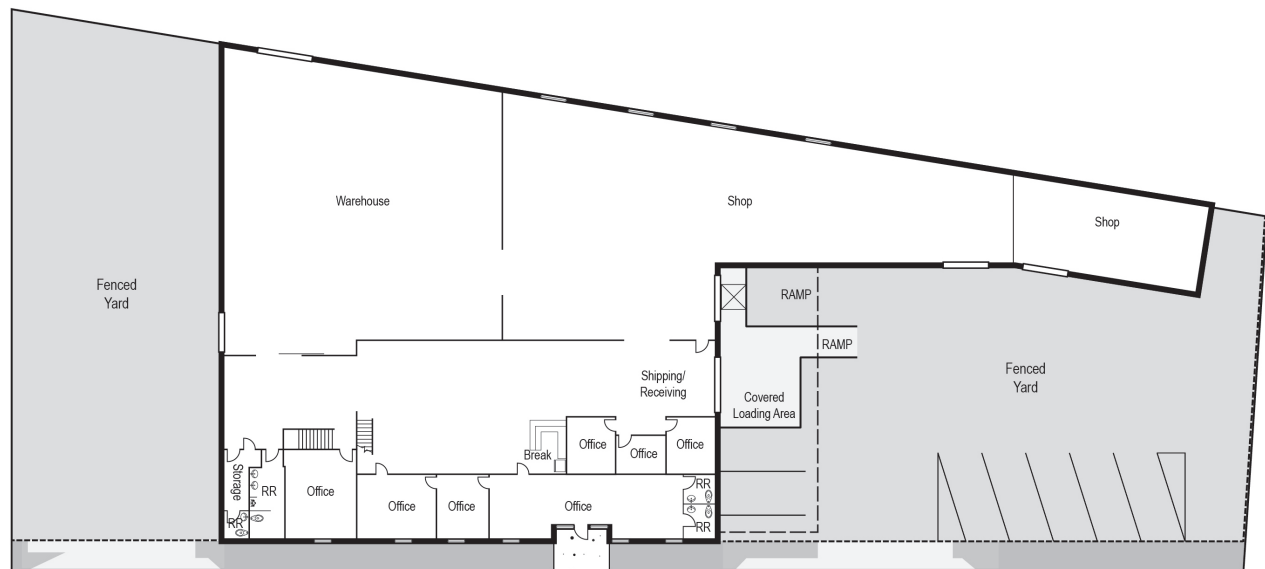

LOS NIETOS RD

Exclusively Offered By:

Voit

REAL ESTATE SERVICES

2020 Main Street, Suite 100 | Irvine, CA 92614
License #01991785 www.voidco.com



LOREN CARGILE
Vice President | Partner
License #01431329

(714) 935-2306
LCargile@voitco.com



MIKE CARGILE
Senior VP | Partner
License #00491668

(949) 263-5338
MCargile@voitco.com